

22 August 2022

Our Ref: 10539476

## **STREET IMPROVEMENTS – INTERSECTION OF EVE STREET AND COULSON STREET, ERSKINEVILLE**

We will soon start work to improve **the intersection of Eve Street and Coulson Street, Erskineville**. These works will increase pedestrian, bike and public transport access while improving safety and greening our streets.

### **What work is being done?**

- New continuous footpath treatment across Eve Street
- New raised pedestrian crossing across Coulson Street
- Street lighting poles for new pedestrian crossing
- Constructing new stormwater pits and pipes
- New concrete footpath
- Road resurfacing
- Existing tree to be removed
- Garden beds
- Kerb extensions
- Tactile installation
- Linemarking

**See overleaf for concept.**

### **When will work start?**

The City's contractor, Sydney Civil, will start work in about **two weeks**. Work will be carried out during the **day** between **7:30am and 5:30pm Monday to Friday, 7:30am and 3:30pm Saturday**. The work is expected to take about **two months** to complete, weather permitting.

### **Will there be any disruption?**

We will take steps to minimise any impact on you. However, there will be some machinery noise, temporary restrictions to vehicle parking and alternative pedestrian access. In the event of wet weather, work will commence the following day. If unsuitable weather continues, we will notify you of the change in scheduling.

Thank you for your cooperation while we carry out these important works.

### **Find out more**

For more information, please contact Sydney Civil community relations team on 1300 997 858 or email [community@sydneycivil.com](mailto:community@sydneycivil.com)

Yours sincerely

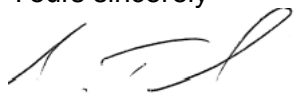

Project Manager  
Craig Taragel

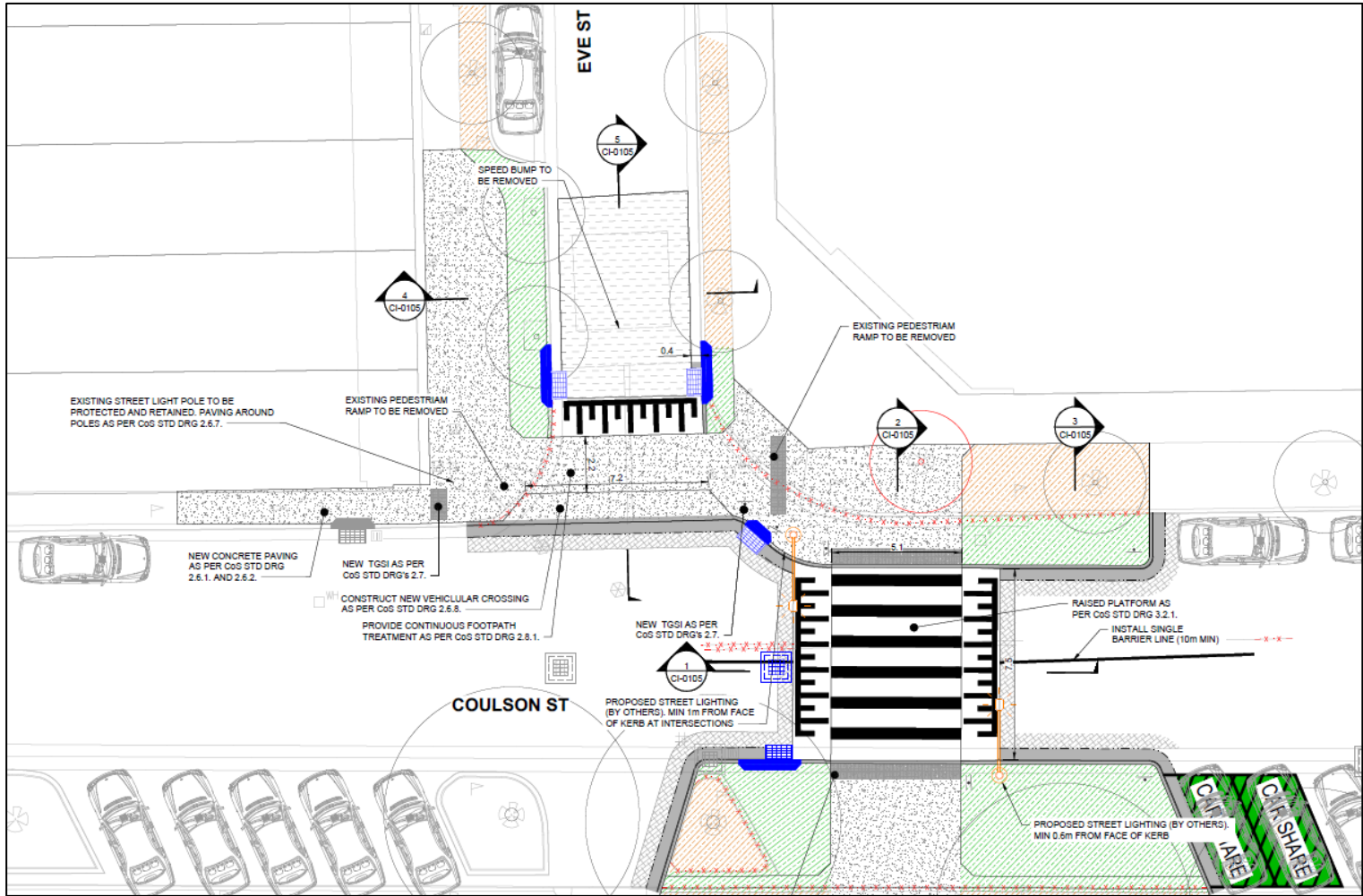

**LEGEND**

- PROPOSED CONCRETE PAVEMENT
- PROPOSED LANDSCAPING REINSTATEMENT
- EXISTING LANDSCAPING
- PROPOSED MILL AND RESHEET
- PROPOSED FULL DEPTH ASPHALT
- PROPOSED NEW KERB AND GUTTER
- TACTILE GROUND SURFACE INDICATORS
- INTERFACE WITH EXISTING PAVEMENT
- EXISTING FEATURE TO BE REMOVED
- EXISTING TREE TO BE RETAINED
- EXISTING TREE TO BE REMOVED
- PROPOSED DRAINAGE PIT